



SMART LIGHTS

# LED SMART GLS GLOBES

## SMTGLS DIMMABLE TRI-CCT + RGB



NO HUB REQUIRED



### Technical Features:

- Input voltage range: 220-240V 50/60Hz
- Housing: plastic & aluminium
- Diffuser: plastic
- Frosted Diffuser
- LED chips: 20pcs SMD2835
- CRI: ≥80
- Power factor: ≥0.5
- Ambient temperature: -20 to 30°C
- App: control all functions via Tuya app on smart devices
- Manual: on/off control via normal wall switch
- Dimmable only via app or voice control through Amazon Alexa, Google Home and other compatible voice activated control devices (Not compatible with wall switch dimmer)
- Setup requires WiFi connection
- Suitable for 2-way switching
- Not suitable for use with sensor

20,000hr  
Lifetime

180°  
Beam Angle

DIMMABLE

2 YEAR  
Replacement  
Warranty

### Additional SMART Features:

- Tuneable RGB colour spectrum (up to 14 million colours)
- Tuneable colour temperature (3000K warm white through to 6500K daylight)
- Works with any 2.4GHz enabled WiFi network (note: will not currently pair with 5.0GHz bandwidth.) or Bluetooth LE 4.2
- Create schedules and timing to automate your home
- Control from anywhere via app or voice control using Alexa Hubs, Google Home and other compatible devices
- Compatible with all Tuya Powered apps



SMTGLS1

SMTGLS2

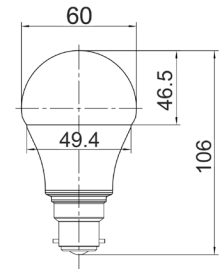
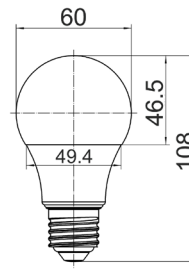

Scan QRCode to download

PART NO.	DESCRIPTION	BASE	KELVIN	LUMENS	WATT	PRODUCT DIMENSIONS	CARTON QTY
SMTGLS1	GLOBE LED SMART ES GLS 10W RGB TRI CCT	E27	RGB+ 3000- 6000K	700-800LM- 3000K 750-880LM- 4000K 750-880LM-6000K	8W	Ø60X108mm	1/10/100
SMTGLS2	GLOBE LED SMART BC GLS 10W RGB TRI CCT	B22		8W	Ø60X108mm	1/10/100	